

RL5426 PLUS

RICE LAKE CANISTER LOAD CELL, IN STAINLESS STEEL, "RL5426" PLUS SERIES



Canister load cells for CE-M approved weighbridges, tanks, silos, etc. Manufactured in STAINLESS STEEL, IP69K protection degree, 6000 divisions.

CAPACITIES: 20 t, 30 t, 40t, 50 t.

OIML R60. C6 precision class.

Stainless steel body. **IP69K** Protection Degree.

20 m armoured rat-proof cable with stainless steel armouring as standard.

h= 118,5 mm.

The best solution
for advanced industrial
applications

• TECHNICAL FEATURES

METROLOGICAL FEATURES

- Rated capacity: (FS): 20t, 30t, 40t, 50t
- Combined error: 0,015 %F.S
- Creep error (after 30 min.): 0,01 %FS
- Temperature effect on zero: 0,02 %F.S./10°C
- Temperature effect on sensitivity: 0,008 %F.S./10°C
- Non-linearity error: 0,01%F.S.
- Non-repeatability error: 0,006%F.S.

OIML R60

- $V_{min} = E_{max}/18000$
- Accuracy class: C6
- Max. number of intervals: 6000e OIML

ELECTRONIC\MECHANICAL FEATURES

- Gas dischargers to protect against atmospheric discharges
- Power Supply: 5÷15 V (AC or DC)
- Rated output at F.S.: $2 \pm 0.0001\%$ mV/V
- Input resistance: $800 \pm 3\Omega$
- Output resistance: $700 \pm 0.01\Omega$
- Insulation resistance: 5000M Ω
- Operating temperature: -35 ~ 70 °C
- Compensated temperature for homologation: -10 ~ 40 °C
- Storage temperature limits: -40° ~ 80°
- Normal service: 120% F.S.
- Maximum load / Safe load: 150% F.S.
- Ultimate overload: 300% F.S.
- IP69K protection degree
- Stainless steel body
- 6-core cable with stainless steel shield, length 20 m, diameter 6mm
- Nickel plated steel cable gland with protective spring
- Self-centring spherical bases
- Equipped with anti-rotation system, to be combined with 173798 cups for proper operation

- CONNECTION

Cable Color Code	
RED	INPUT +
BLACK	INPUT -
GREEN	OUTPUT +
WHITE	OUTPUT -
YELLOW	SENSE +
BLUE	SENSE -
METAL	Shield

- INSTALLATION KIT

- The 173798 kit allows a correct installation of the RL5426 load cells below the weighbridge plate.
- The kit consists of an upper cup and a lower cup with anti-rotation system. All components are made from stainless steel. Both cups are designed for optimal operation in conjunction with the cell's self-centring spherical bases, allowing their proper oscillation and return to position.

DETAIL 1

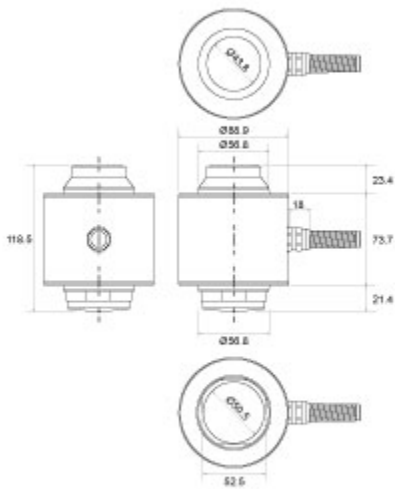

VERSIONS

Available versions

Codice		Max (kg)
<u>RL5426-20T</u>		20 000
<u>RL5426-30T</u>		30 000
<u>RL5426-40T</u>		40 000
<u>RL5426-50T</u>		50 000



DINI ARGEO
FRANCE sarl
France

DINI ARGEO
GMBH
Germany

DINI ARGEO
UK Ltd
United Kingdom

DINI ARGEO WEIGHING
INSTRUMENTS Ltd
China

DINI ARGEO
OCEANIA
Australia



COMPANY HEADQUARTERS

Via Della Fisica, 20
41042 Spezzano di Fiorano Modena • Italy
Tel. +39.0536 843418

SERVICE ASSISTANCE

Via Dell'Elettronica, 15
41042 Spezzano di Fiorano Modena • Italy
Tel. +39.0536 921784

SALES AND TECHNICAL ASSISTANCE SERVICE