

RL5426DC

RICE LAKE DIGITAL CANISTER LOAD CELLS, IN STAINLESS STEEL,
"RL5426DC" SERIES WITH CONNECTORS



Digital canister load cells for CE-M approved weighbridges, tanks, silos, etc. Manufactured in STAINLESS STEEL, IP68 protection degree, 6000 divisions.

Specifically developed for working without junction box.

CAPACITIES: 30 t, 40 t

OIML R60. C6 precision class.

Stainless steel body. **IP68** Protection Degree.

h= 118,5 mm.

The best solution
for advanced industrial
applications

• TECHNICAL FEATURES

METROLOGICAL FEATURES

- Rated capacity: (FS): 30 t, 40 t
- Combined error: 0,015 %F.S
- Creep error (after 30 min.): 0,01 %FS
- Temperature effect on zero: 0,02 %F.S./10°C
- Temperature effect on sensitivity: 0,008 %F.S./10°C
- Non-linearity error: 0.01%F.S.
- Non-repeatability error: 0.006%F.S

OIML R60

- $V_{min} = E_{max}/18000$
- Accuracy class: C6
- Max. number of intervals: 6000e (EC Test Certificate, according to OIML R60 (2000))

ELECTRONIC\MECHANICAL FEATURES

- Gas dischargers to protect against atmospheric discharges
- Double connector for load cells interconnection and weight indicator connection, without junction box.
- Halfduplex RS485 communication technology
- Rice Lake communication protocol
- Power Supply: 8÷15 V (AC or DC)
- Rated digital output: 60000 d
- Current consumption: 35 mA
- Internal resolution: 24 bit
- Converter rate: max. 40 conv./sec.
- RS485 communication speed: Max 100kHz.
- Operating temperature: -35 ~ 70 °C
- Compensated temperature: -10 ~ 40 °C
- Storage temperature limits: -40 ~ 80 °C
- Normal service: 120% F.S.
- Maximum load / Safe load: 150% F.S.
- Ultimate overload: 300% F.S.
- IP68 protection degree
- Stainless steel body
- 4-core RS485 cable as optional with stainless steel shield, diameter 7mm
- Self-centring spherical bases
- Equipped with anti-rotation system, to be combined with 173798 cups for proper operation

• CONNECTION

CABLE COLOR CODE	
RED	EXC +
BLACK	EXC -
GREEN	A +
WHITE	B -
METAL	SHIELD

• INSTALLATION KIT

- The 173793 kit allows a correct installation of the RL5426DC load cells below the weighbridge plate.
- The kit consists of an upper cup and a lower cup with anti-rotation system. All components are made from stainless steel. Both cups are designed for optimal operation in conjunction with the cell's self-centring spherical bases, allowing their proper oscillation and return to position.

DETAIL 1

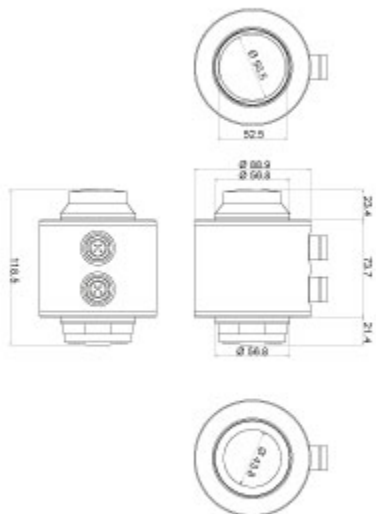

DETAIL 2

VERSIONS

Available versions

Codice	Max (kg)
RL5426DC-30T 	30 000
RL5426DC-40T 	40 000



DINI ARGEO
FRANCE sarl
France

DINI ARGEO
GMBH
Germany

DINI ARGEO
UK Ltd
United Kingdom

DINI ARGEO WEIGHING
INSTRUMENTS Ltd
China

DINI ARGEO
OCEANIA
Australia



COMPANY HEADQUARTERS

Via Della Fisica, 20
41042 Spezzano di Fiorano Modena • Italy
Tel. +39.0536 843418

SERVICE ASSISTANCE

Via Dell'Elettronica, 15
41042 Spezzano di Fiorano Modena • Italy
Tel. +39.0536 921784

SALES AND TECHNICAL ASSISTANCE SERVICE